



70, Birchwood Road, Wilmington DA2 7HG
Asking Price £900,000



Located on the prestigious Birchwood Road, this deceptively spacious five / six bedroom detached chalet bungalow presents an exceptional opportunity for further development, subject to the relevant planning permissions. Behind its modest frontage lies a remarkably generous home, thoughtfully arranged to suit both family living and entertaining.

The ground floor welcomes you with an entrance porch leading into a bright entrance hall, giving access to three well-proportioned bedrooms, a family bathroom, and a comfortable reception room. To the rear, the property opens into a stunning modern open-plan kitchen, dining, and living space—beautifully designed and overlooking the garden, creating the true heart of the home.

Upstairs, a spacious landing leads to two impressive double bedrooms, each benefitting from en-suite facilities and ample built-in storage.

Externally, the property is approached via a large driveway providing extensive off-street parking. The rear garden extends to approximately 133ft and offers a secluded retreat, complete with an outbuilding and dedicated entertaining areas—ideal for outdoor living.

Birchwood Road is perfectly positioned for highly regarded local schools, including Wilmington Grammar and Wilmington Academy, as well as convenient access to local shops, Birchwood Park Golf and Country Club, and excellent transport links via the A2 and M25. Viewing is strongly recommended to appreciate both the scale of accommodation and the exciting potential this property offers.

Local Authority: {prop_LA_county}

Council Tax Band: {council_tax_band}



01322 553322

60-62 High Street, Bexley, Kent, DA5 1AH

bexley@parkestates.co.uk
www.parkestates.co.uk

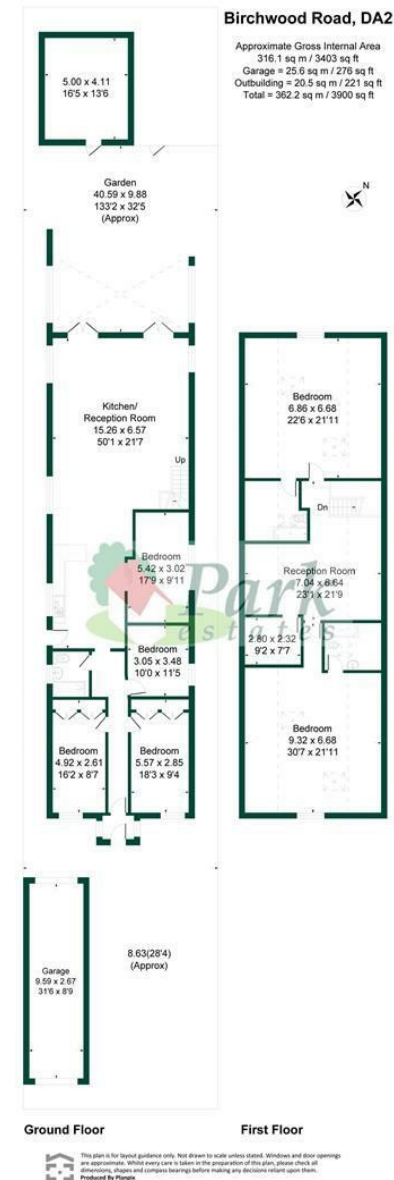

Every care has been taken with the preparation of details, but accuracy is in no way guaranteed. These particulars do not constitute a contract and are issued and accepted on the express understanding that all negotiations will be conducted through Park Estates. The seller does not make or give, nor do we or our employees have any authority to give a representation or warranty in relation to the property. Please contact this office before viewing the property. If there is any point which is of particular importance to you, we will be pleased to check the information for you and confirm that the property remains available. This is particularly important if you are contemplating travelling some distance to view the property. We would strongly recommend that all the information that we provide about the property is verified by yourself on inspection and also by your conveyancer, especially where statements have been made by us to the effect that the information provided by us has not been verified.